

Design Aid 3.12.4 Partial Interaction Curves for Prestressed Hollow-Core and Sandwich Wall Panels

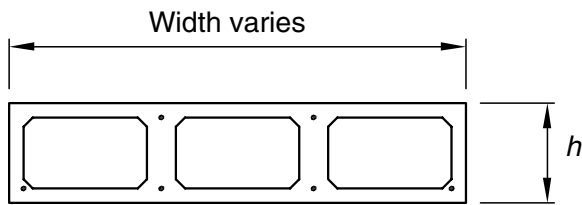

Curves based on minimum practical prestress no less than 225 psi normalweight concrete

$f'_c = 5000$ psi, normalweight

$f_{pu} = 270,000$ psi

Width and configuration may vary

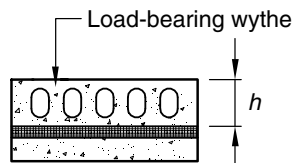

Partially composite or non-composite

Mark	h , in.	Full interaction curve data						
		ϕP_o	Partially developed strand force			Fully developed strand force		
			ϕP_{nb}	ϕM_{nb}	ϕM_c	ϕP_{nb}	ϕM_{nb}	ϕM_c
HC6	6	127	103	10	2.4	58	10	3.9
HC8	8	145	128	16	3.7	65	16	6.0
HC10	10	175	153	22	5.6	78	25	9.1
HC12	12	177	178	30	6.7	78	32	11.3

Units for ϕP are kip, units for ϕM are kip-ft.
Values are for 1 ft width.

Partially developed strand

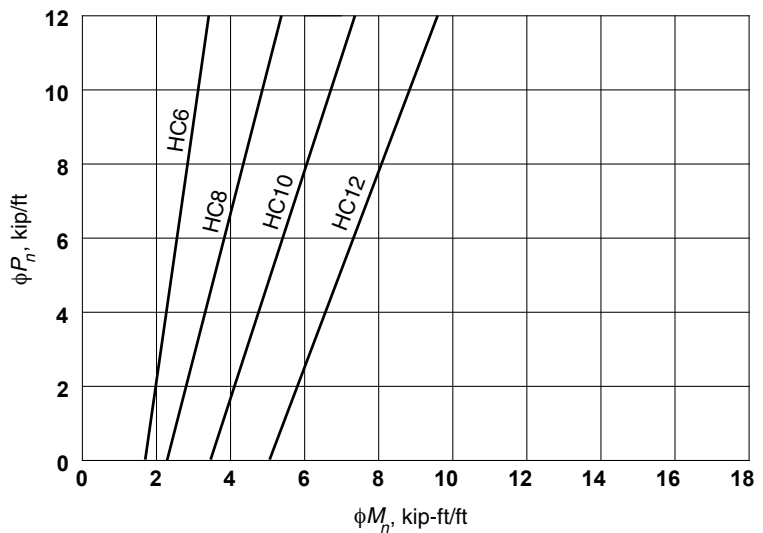

Fully developed strand

